

REMOTE MOUNT CYLINDERS



Perfect For
Remote Operation
Of Trailer Tailgates

Remote Mount Cylinders
Pull Type

Which Dependability Matters...

Count on MGM Remote Cylinders

Built durable for tough jobs!

MGM MGM Brakes Form 5000

Remote Mount Cylinders
Pull Type

SAAR & SAHR Driveline Brakes...

SAAR Model
Spring Applied
Hydraulic Release

SAHR Model
Spring Applied
Air Release

Now In
our line of
remote
cylinders

Compact Design, Light Weight!

MGM MGM Brakes Form 5000



Section 8: Remote Mount Cylinders.....

91-95



R4A

Remote Cylinder.....

92-93



R5AHD

Remote Cylinder, Heavy-Duty.....

92-93

R7A (SAAR) Remote Cylinder, Spring Applied, Air Released.....

94-95



R8H (SAHR) Remote Cylinder, Spring Applied, Hydraulic Released.....

94-95



MGM Brakes R4A & R5AHD Remote Mount Cylinders...are the original spring brake invented in the rugged logging country of Northern California. These cylinders were introduced by MGM Brakes in 1956 as the world's first spring-actuated parking and emergency brake actuators for commercial vehicles. These "pull-to-actuate" cylinders were designed for axle-mount using various weld-on and bolt-on mounting brackets and linkage arms.

R7A (SAAR) and R8H (SAHR) drive-line brakes are developed as replacements for manually operated lever applied "drive-line" brakes. Mounted to the frame rail, the actuator utilizes a cable to apply parking force to a drum mounted on the drive-line. An optional electronic "travel" sensor provides the operator with information pertaining to the position of the push rod - "applied" or "released".

Today, these high-quality air-actuated cylinders have been adapted to such diverse non-automotive usage as dump truck end-gate actuators, emergency brake actuators on massive logging and commercial fishing winches and numerous other special applications.

How Remote Mount Cylinders Operate

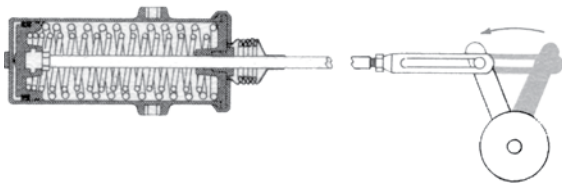

When the end-gate is closed, spring pressure within the cylinders moves the latches into the latched position, reducing the risk the end-gate may inadvertently swing open.

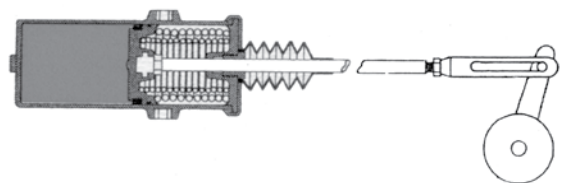

To unlatch the end-gate, the operator applies air to the cylinder through a valve located in the cab of the vehicle. As air pressure builds within the cylinder it forces the piston to move, compressing the spring(s) and extending the push-rod which moves the end-gate latches into the open position.

NOTE: Product information and specifications subject to change without notice.

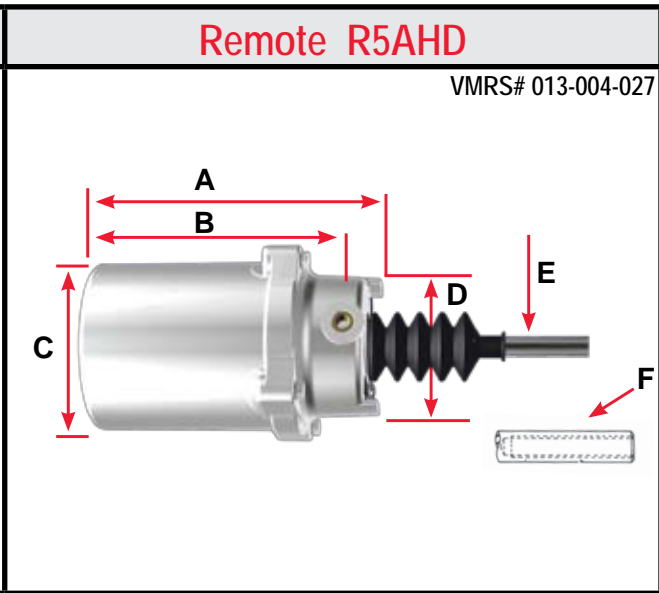
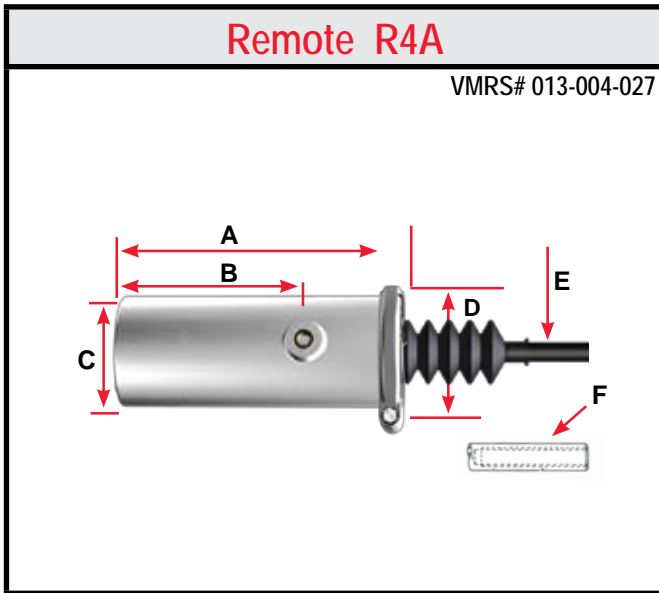

P/N Series	5004	5005
Model	R4A	R5AHD
Size	4	5
Stroke	4.50" (114.3 mm)	4.20" (106.7 mm)
P/N External 20" (508.0 mm) Rod	5004010	N/A
P/N External 15" (381.0 mm) Rod	5004013	5005012
P/N Internal 7" (177.8 mm) Rod	5004014	5005014
Wt. Combination (lb/kg)	13.5 lb (6.1 kg)*	19.6 lb (8.9 kg)*
A	11.12" (282.4 mm)	10.50" (266.7 mm)
B	7.50" (190.5 mm)	9.38" (238.3 mm)
C	4.38" (111.3 mm)	6.12" (155.4 mm)
D	5.69" (144.5 mm)	5.12" (130.0 mm)
E (External Thread)	3/4" - 16 UNF x 10.75" (273.1 mm) long	
F (Internal Thread)	1/2" - 20 UNF x 3.00" (76.2 mm) DEEP	
Inlet	3/8" - NPTF	

NOTE: * Weight varies with external rod size.

Standard Assembly Part Numbers & Service Parts	
Part Number	Description Of Parts
9004003	Kit - Boot & Clamp - Remote
9008001	Kit - Side Bushings R4A/R5AHD (for Trunnion Bolt Mount)

NOTE: Product information and specifications subject to change without notice.

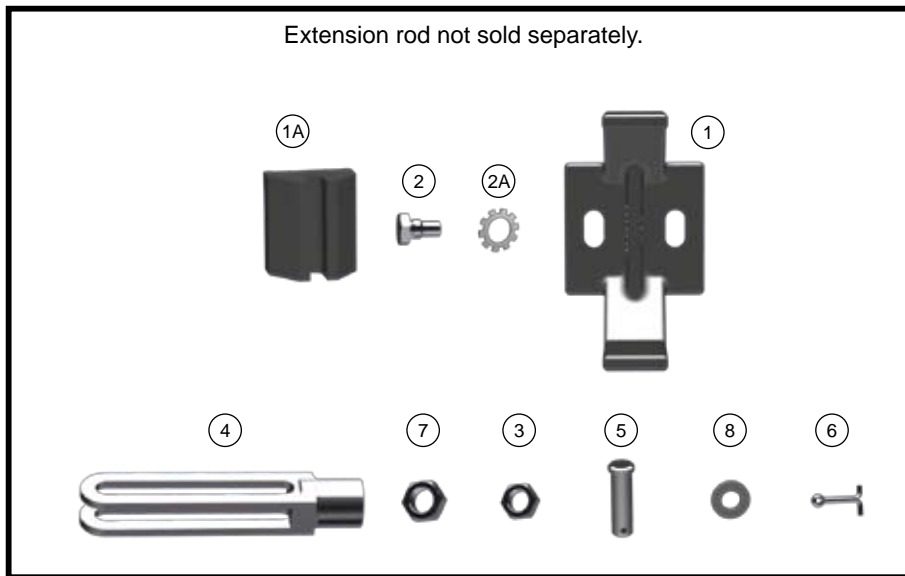

Assemblies			Kit P/N and Quantities			
Model	P/N	Rod Specifications	9050019	9050027	9050028	9050035
R4A	5004010	External Thread 20.00" (508.0 mm)	2			
R4A	5004013	External Thread 15.00" (381.0 mm)		1		
R4A	5004014	Internal Thread 7.00" (177.8 mm)				1
R5AHD	5005012	External Thread 15.00" (381.0 mm)			1	
R5AHD	5005014	Internal Thread 7.00" (177.8 mm)				
Key	P/N	Part Description				
1	8005001	Gimbal Bracket - R4A	2	1		1
1	8005013	Gimbal Bracket - R5AHD			1	
1A	8062001	Shock Pad - R4A	2	1		1
1A	8062002	Shock Pad - R5AHD				
2	8003003	Trunnion Bolt	4	2	2	2
2A	8141002	Star Lock Washer	4	2	2	2
3	8130011	Hex Nut 1/2"- 20 UNF				
4	8092006	Sliding Clevis 1/2"- UNF				
5	8038001	Yoke Pin 1/2" (12.7 mm)				
6	8151001	Cotter Pin				
7	8130002	Hex Nut 3/4"- 16 UNC	4			
8	8140002	Lockpin Washer 3/4" (19.1 mm) (inside diameter)	2			

NOTE: Product information and specifications subject to change without notice.

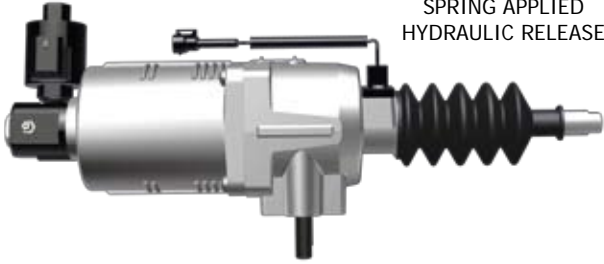
Remote R7A	Remote R8H
 <p>VMRS# 013-004-027 R7A (SAAR) MODEL SPRING APPLIED AIR RELEASE</p>	 <p>VMRS# 013-004-027 R8H (SAHR) MODEL SPRING APPLIED HYDRAULIC RELEASE</p>

R7A (SAAR) & R8H (SAHR) Model Features

- Compact Design
- Light Weight Aluminum
- Electronic Stroke Sensor

Service Kits & Replacement Parts

1	9051001	Sensor Kit - R7A (SAAR) & R8H (SAHR)
1A	9051004	Sensor Kit - Blue Diamond Application
2	9041005	Cartridge - R8H (SAHR) Hydraulic Unit
3	8004002	Boot - R7A (SAAR)
3A	8004010	Boot - R8H (SAHR)

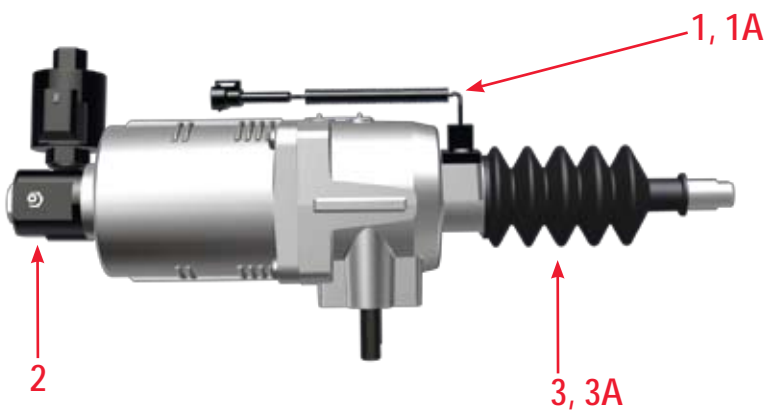

NOTE: Product information and specifications subject to change without notice.

R7A (SAAR) and R8H (SAHR) Drive-line Brakes were developed as replacements for manually operated lever applied "drive-line" brakes on class 6 and 7 vehicles. Mounted to the frame rail, the actuator utilizes a cable to apply parking force to a drum mounted on the drive-line. An optional electronic "travel" sensor provides the operator with information pertaining to the position of the push rod – "applied" or "released".

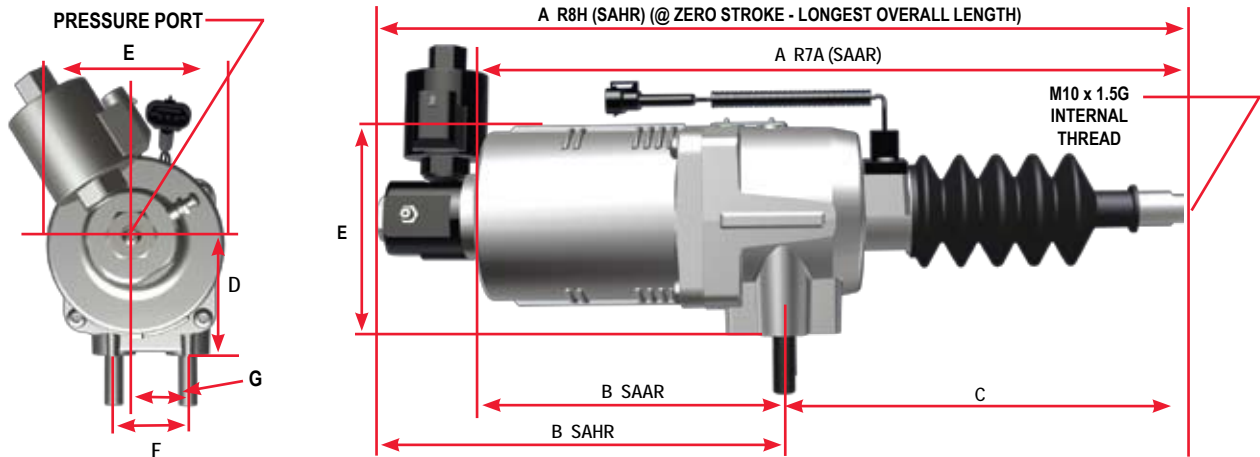

Model	SAAR	SAHR
Series	R7A	R8H
Part Number	5007001	5008001
Stroke of Unit	2.75" (69.8 mm)	2.75" (69.8 mm)
Operating Pressure	130 PSI (9.0 Bar)	2320 PSI (160.0 Bar)
Temperature Range	-40°F/+190° F (-40° C/+ 88° C)	-40° F/+190° F (-40° C/+ 88° C)
Weight – estimated	6.91 lb (3.1 kg)	8.7 lb (3.9 kg)
A	15.46" (392.7 mm)	18.05" (458.5 mm)
B	6.51" (165.4 mm)	9.10" (231.1 mm)
C	8.95" (227.3 mm)	
D	2.50" (63.5 mm)	
E	4.50" (114.3 mm)	
F	1.93" (49.0 mm)	
G	1.20" (30.5 mm)	

NOTE: Product information and specifications subject to change without notice.